

## BEAM BENDER 2.0"/50.8mm DIA. (35mm CA)

### FEATURES

- 1.4"/35mm CLEAR APERTURE (CA)
- ORTHOGONAL ADJUSTABLE MIRROR +/- 2 DEGREES
- INPUT/OUTPUT & SIDE MOUNTING OPTIONS
- PRECISION ADJUSTMENT SCREWS (WRENCH OR THUMB)
- INDIRECT MIRROR COOLING
- EASY MIRROR REPLACEMENT
- ALUMINUM CONSTRUCTION
- INTERLOCK (OPTIONAL)

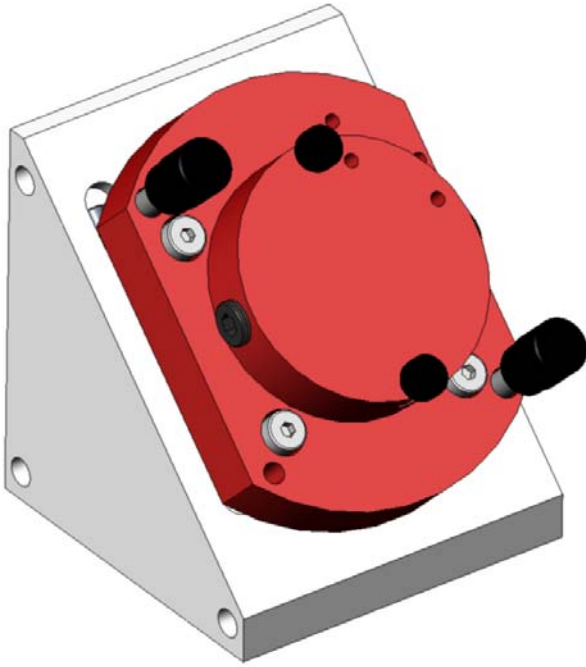

### SPECIFICATIONS

- PART NUMBER: **080003**
- MIRROR DIAMETER: **2.0"/50.8mm**
- COOLING PORTS: **1/8 NPT**
- WEIGHT: **3.25 lbs/1.74 kg**

